

HOP WiFi® Self-Install Instructions

In this kit you will receive:

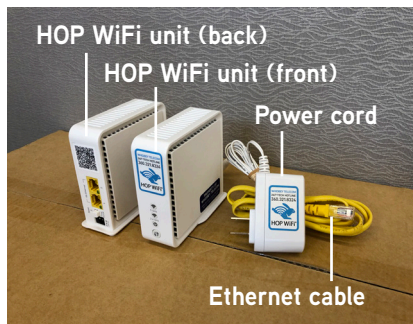

- HOP WiFi unit
- Power cord
- Ethernet cable
(May be either yellow, blue, white, black or grey. The color does not matter.)

Step One: Connect HOP WiFi

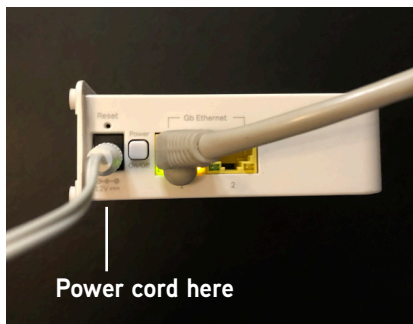

- Find a central location to place the WiFi to enable the signal to travel more effectively throughout the home.
- Connect the power cord to the HOP WiFi unit.
- Plug the other end into an electrical outlet.

Step Two: Connect WiFi to Modem



- Connect the ethernet cable to the HOP WiFi unit Port 1.
- Connect the other end of the cable to your modem. This can be any of the ETH ports, as seen above. (The ports on your modem may also be labelled LAN.)

Step Three: Activate Equipment



- The HOP WiFi is already pre-configured with the network name and password below.
- If no lights, ensure power button is depressed. All lights will blink initially. After 2-12 minutes, the power light and 2.4G LED will be steady. 5G LED will blink periodically.

Network Name: _____

Password: _____